

Safety

1. The lighting fitting should be installed, repaired and maintained by a person with the appropriate qualifications. Incorrect installation or tampering carries a risk of electric shock.
2. Installation of the lighting fitting must be carried out in accordance with its purpose and these instructions.
3. When installing lamps in an open air, never connect power supply in wet conditions.
4. When connecting the lighting fitting to the power network, make sure that the power supply parameters correspond to the rated power. Make sure to connect the protective conductor. After connecting the lighting fitting is energised.
5. Do not touch the device with wet or damp hands.
6. Be very careful when touching the lamp fixture during its work. The following parts – diffuser with lens (especially!), housing top (especially!), housing bottom and support arms – may get very hot! For any maintenance works, wait long enough to allow those parts to cool down.
7. In case of suspicion of damage to the electrical part of the device (driver, connectors, power cord), do not use the lighting fitting.
8. The device should be mounted in such a way that enables natural heat dissipation. Especially, it is forbidden to cover either totally or even partially the diffuser with lens, as well as both top and bottom part of the housing. Those elements must stay uncovered to enable proper heat dissipation.
9. Periodical maintenance should be done in order to assure proper operations.
10. The manufacturer does not guarantee proper operation and shall not be responsible for any damage or injury resulting from installation, repair or maintenance performed in contrary to the instructions, generally accepted principles of installation, occupational safety rules, intended use or when the installation was performed by a person without appropriate permissions.

Protection of environment

1. Cardboard or paper elements of the packaging should be sent for paper recycling or disposed of into a container for paper waste, while plastic packaging into a container for plastic waste.
2. Obsolete lighting fitting must not be disposed of as household waste and should be delivered to a special WEEE collecting point.

Guarantee

1. The guarantee is valid for 24 months from the date of purchase.
2. The guarantee shall not cover mechanical damage, damage caused by improper installation, operation or modifications of the lighting fitting as well as changes occurring due to natural wear and tear of the product.
3. The manufacturer reserves that it does not take any responsibility for the improper operation of the lighting fitting as a result of interference in the lighting fitting construction carried out by the user without permission.
4. Application of the lighting fitting: exterior lighting (pavements, residential areas, recreation fields, etc.)

Handling of obsolete equipment



Pursuant to the Act of 29 July 2005 on waste electrical and electronic equipment and the Act of 24 April 2009 on batteries and accumulators, the presented device, after use, due to hazardous substances contained in it, is subject to collection of waste electrical and electronic equipment. Detailed information on WEEE collection can be obtained from municipal authorities.



Intelight Sp. z o.o.
8, Rydygiera st.
PL-01 -793 Warszawa

EXTERIOR LAMPS

PROMENAD LED Indirect



Version:

PROMENAD LED Indirect

INSTALLATION AND OPERATION INSTRUCTIONS

Power supply	Source	Colour options	Mounting on poles	IP rating	Insulation class
230 VAC / 50Hz	LED	Black RAL 9005 Grey RAL 7045	Ø60, Ø48*, Ø42*	IP66	I

* requires special adapter

Temperature	Working range	Maximum temperature
	Ta = -30°C ÷ +40°C	Tc point = max. +125°C, on top of the diffuser, at Ta = +25°C

Versions	Source power	Total power
Promenad LED Indirect 30	LED 24W	29 W
Promenad LED Indirect 45	LED 36W	42 W

Dimensions and weights	
Diameter [mm]	650** 223***
Height [mm]	509** 214***
Weight [kg]	6,2

/ with/without reflector
*** without pole

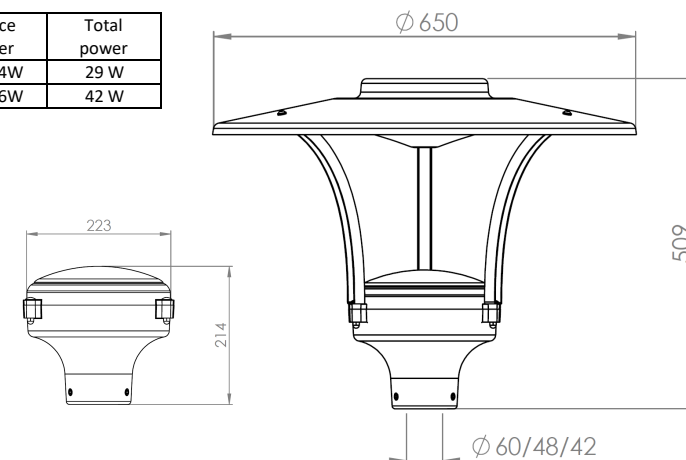

Installation of the light fitting

Introductory information

1. Prior to installation, remove the light fitting from the box and read the following instructions for assembly and use.
2. Be sure that the mains supply is off.
3. Define the diameter of a pole (8), on which the lamp is to be fixed (pole is not a part of a lamp kit).
4. Depending on the diameter, installation could require a special adapter (7). For Ø60 no adapter is needed. Poles Ø48 and Ø42 require special adapter, different for each of them (included in a kit).
5. The lamp is delivered two separate sets: lamp body set (A) and hat-reflector set (B).
6. The lamp body set (A) is being delivered pre-assembled (except for step down rings and with a remark that support arms need to be rotated).
7. The hat-reflector set (B) is being delivered pre-assembled, only hat assembly nuts and washers (9, 10 and 11) are being delivered unassembled.
8. The step down rings (for Ø48 and Ø42 poles) are not pre-installed, they are being delivered as additional accessories.
9. The lamp is being delivered with a 4m long power cable (already wired).

Assembly of a lamp on a pole

10. Prior to the assembly, please check what is diameter of a pole. The installation is possible on poles with the following diameters: 60mm, 48mm and 42mm. If your pole has 60mm diameter, you can install the lamp base on the pole directly. If it is 48mm or 42mm – you need to use a proper step down ring (they are clearly marked – 98230/48 or 98229/42 – make sure you used the right one). Put the proper ring (7) into the round mounting slot in bottom part of a lower part of a body (6). Make sure the inset on the ring is aligned with the recess inside the slot. The shape of a ring assures it springs into the slot, there is no need to fix it at this stage.
11. Conduct the power cable through the mounting pole.
12. Put the lamp body (with or without a step down ring, depending on a pole diameter) on a mounting pole. Make sure it is inserted to the end (about 75-78mm), then fix it by means of screws (12).

Assembly of support arms and a hat-reflector

13. Rotate all the three support arms (3) as shown on picture, so that they are ready for a hat-reflector set (B) installation. At this stage don't screw them on.
14. Prepare the nuts (9) and washers (10 and 11) for the hat-reflector installation.
15. Hat-reflector (1) has three holes prepared for screws. Put the hat-reflector set (1) on support arms (3), make sure that all the holes are aligned with screw threads on upper part of each support arms (3).
16. Screw initially all the three sets of fixings (9, 10 and 11) on screw threads on the arms (3). Start with rubber washer (11), then put metal washer (10), then use the nut (9).
17. Make sure that all the elements are perfectly aligned, especially the arms (3) versus both the hat-reflector (1) and the lamp body (6). Then screw firmly all the fixings – hat nuts (9) as well as support arms' fixings on the lugs on bottom part of the lamp body (6).
18. The assembly is complete.

Power connection and final info

19. To finalise installation, connect the power cable to the power connector / terminal block. Each wire should be connected according to standard colour and marking. The three-core cable must be connected as follows: phase wire to "L", neutral wire to "N", protective wire to "PE".
20. Before the final start up, make sure that all mechanical and electrical connections have been carried out correctly and are safe.
21. The lamp is ready to be powered.
22. Before any maintenance, repair or disassembly, disconnect the lamp from the power network and wait at least a couple of minutes in order to allow to all elements of the lamp (especially upper part of a body (5) or a cover (4)) to cool down.
23. Adherence to these instructions and safety rules ensure efficiency of the lighting fitting and its safe use.
24. Note: in a case you needed additional assembly tips or there is a difference between instructions and the delivery set, please, contact your regional sales office for more information.

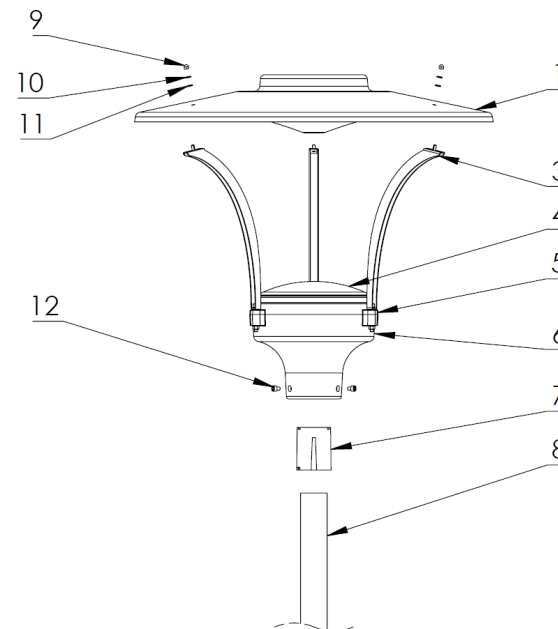

Support arms assembly

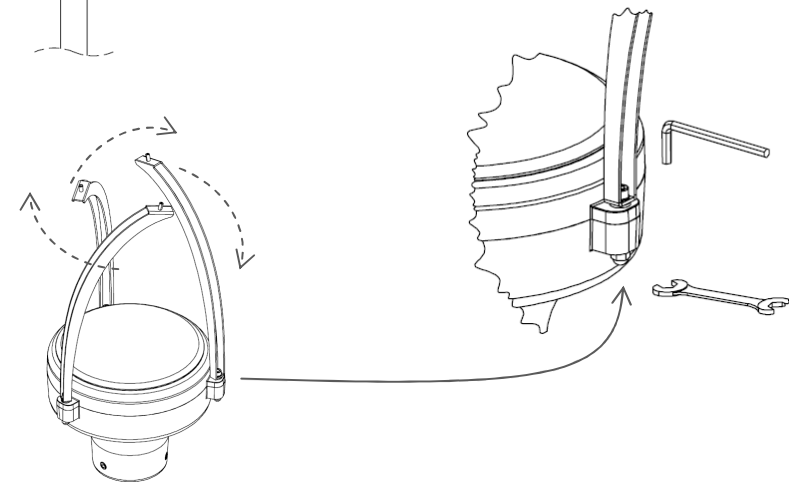

Hat-reflector assembly

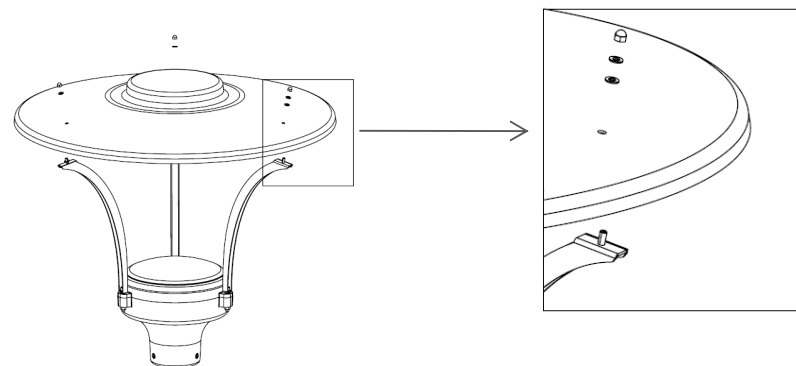

Lamp elements

- 1 – hat-reflector
- 3 – support arms
- 4 – diffuser with lens
- 5 – housing – top part (heat sink)
- 6 – housing – bottom part
- 7 – step down rings
- 8 – pole
- 9 – hat assembly nuts
- 10 – hat assembly metal washers
- 11 – hat assembly rubber washers
- 12 – pole fixing screws

Delivery sets (for lamps delivered in 2 sets)

A. Lamp body set

Parts assembled: 3, 4, 5, 6, and 10 (3 pcs)

Other parts: 7 (2 pcs, sizes: 48, 42)

B. Hat-reflector set

Parts assembled: 1

Parts not assembled: 9 (3 sets), 10 (3 sets),
11 (3 sets)